

## **Bibliography details**

**Name of the Serial/Publication:** Veritas

**Volume No.:** 1

**Issue No.:** 2

**Month & Year of publication:** February 2022

**Page numbers:** Feature Articles (34-37)

**Title of Article:** The journey from crime to judgement

**Contributor (s)**

1. Ms. Catherine Maria Johny

# THE JOURNEY FROM CRIME TO JUDGEMENT



Ms. Catherine Maria Johny



When a crime takes place, it should be first reported to the police station. The first responder needs to record the initial receipt of information. It should include:

- Date and time.
- Method of transmission.
- Identity of the person giving information.
- Weather condition.
- Location of dispatch.
- Brief details.

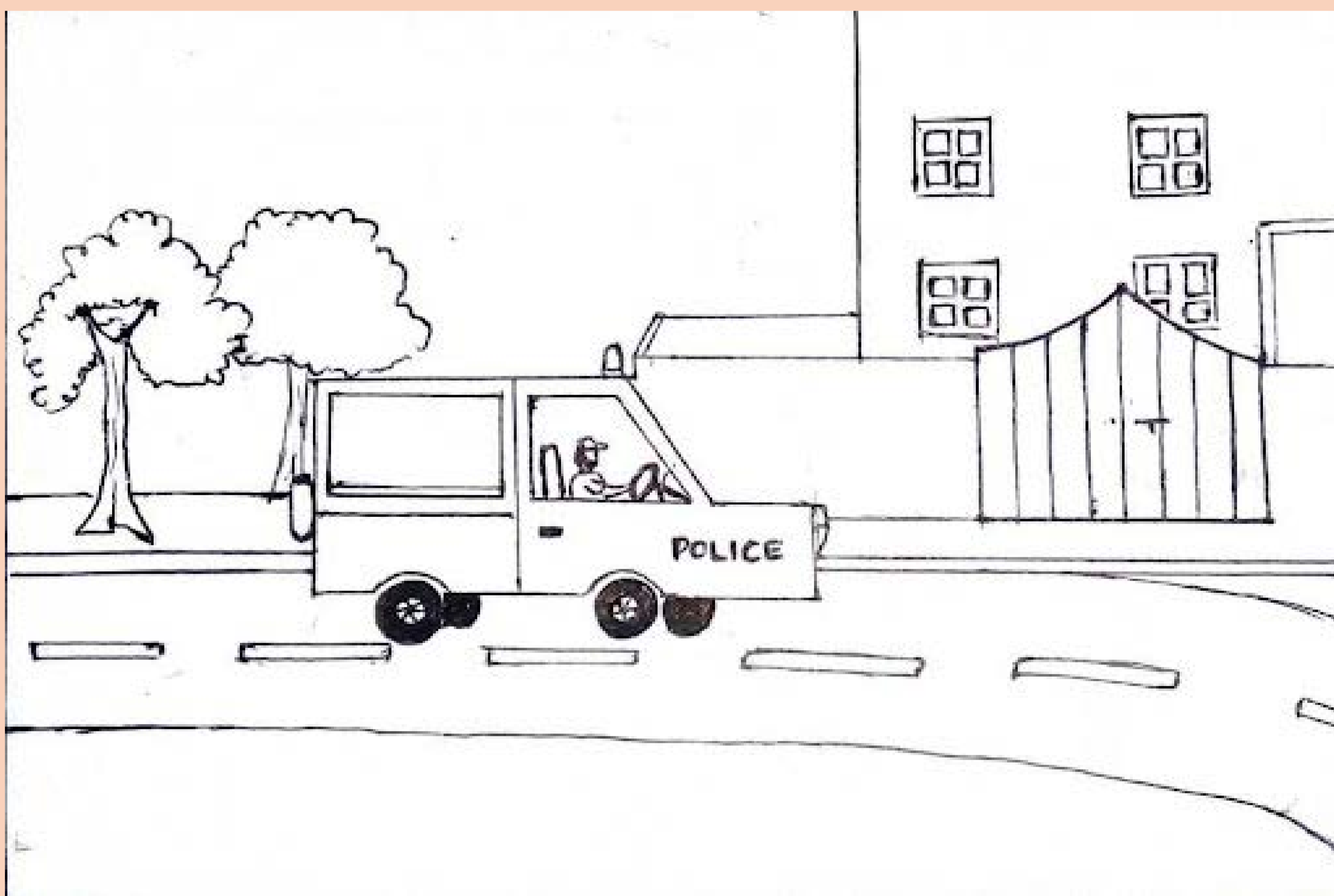

After arriving at the scene, the primary responsibility is to assist the victim and give necessary aid. He should then protect the crime scene by removing unnecessary people like relatives, media, curious or unauthorized people etc. and implement strict security measures like taping off the area, assigning security officers etc. He should separate the witnesses and avoid interaction among them. Then he can proceed to record other details such as time of arrival, location, scene description, weather conditions. He should also be aware of the people present: police personnel and non-police personnel.

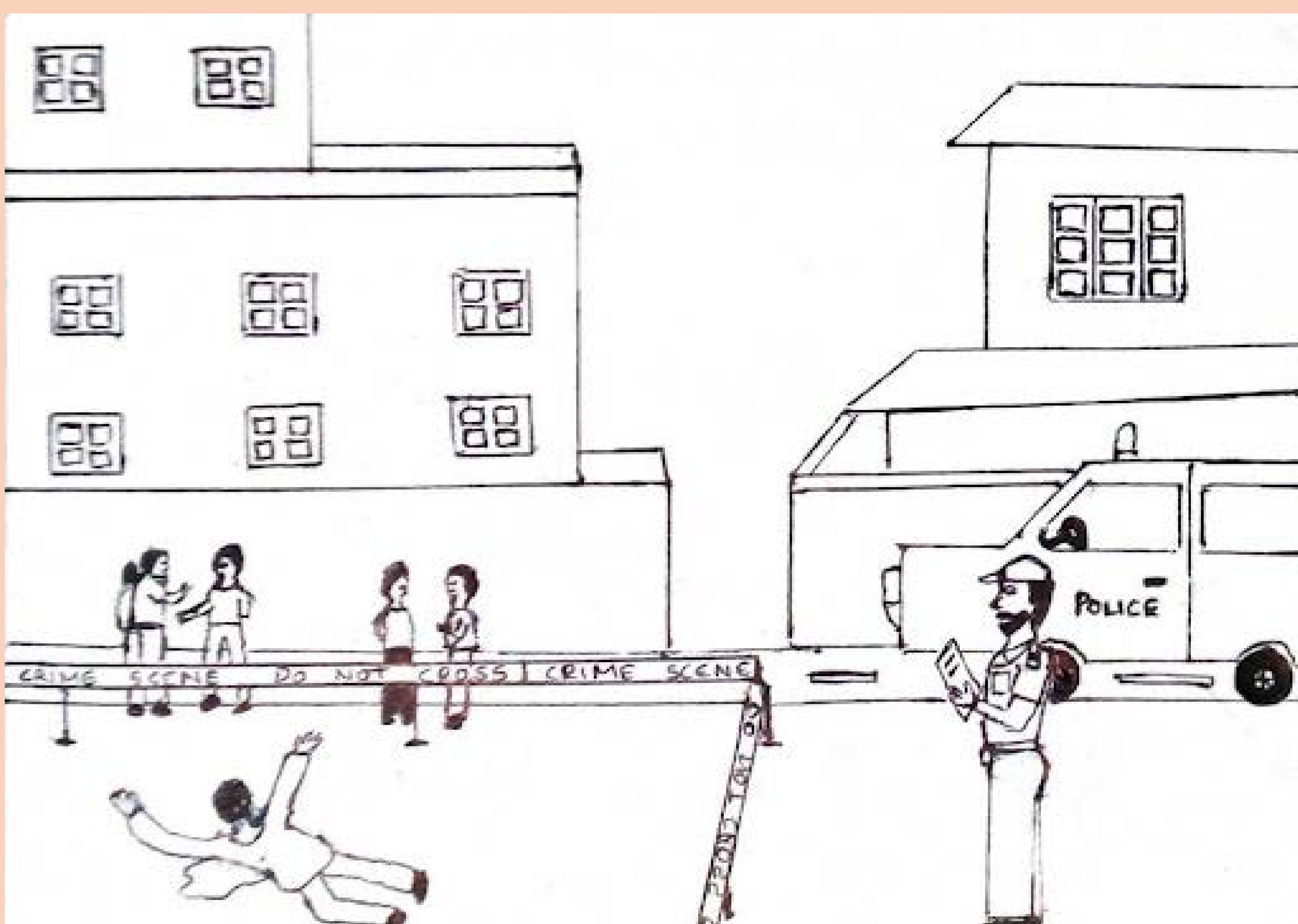



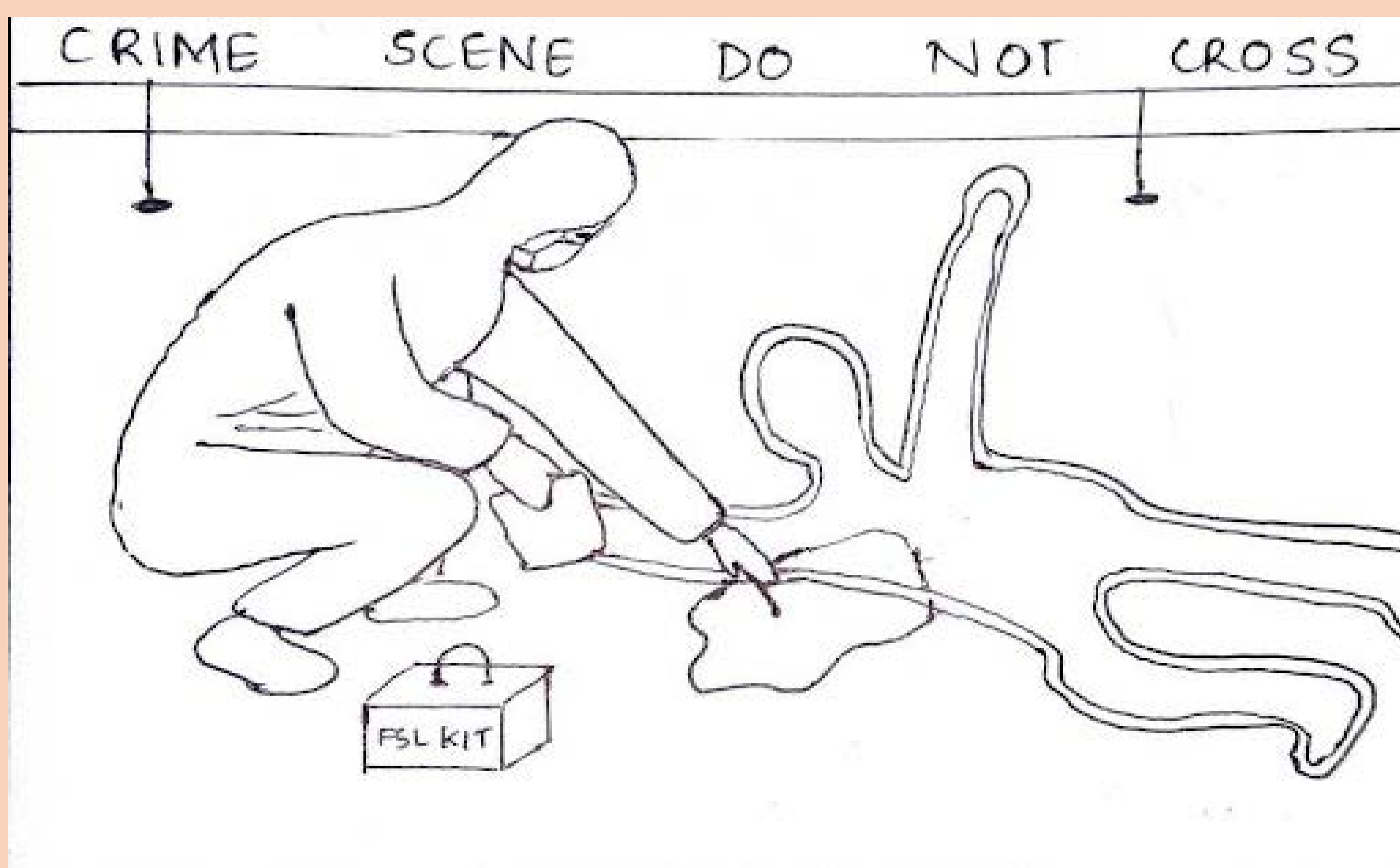

He should have a crime scene log having the information of the people who entered the scene with the time of arrival and their qualification. He should record the scene as it is using photography equipment. He should identify the evidence and preserve it according to the situation. When the forensic team arrives, he should inform the details of the crime and the present status. All information should be communicated to the investigating officer. Then the evidence can be collected and analyzed in the Forensic Science Laboratory.

Based on the evidence collected, each of them is transferred to its respective department, like hair to the biology division, guns to the ballistics division etc. The evidence is carefully preserved and analyzed in the laboratory to avoid tampering and the seal placed on the evidence covering should be intact while it is received. Any kind of tampering should be noted by the forensic department and should be mentioned in the report.

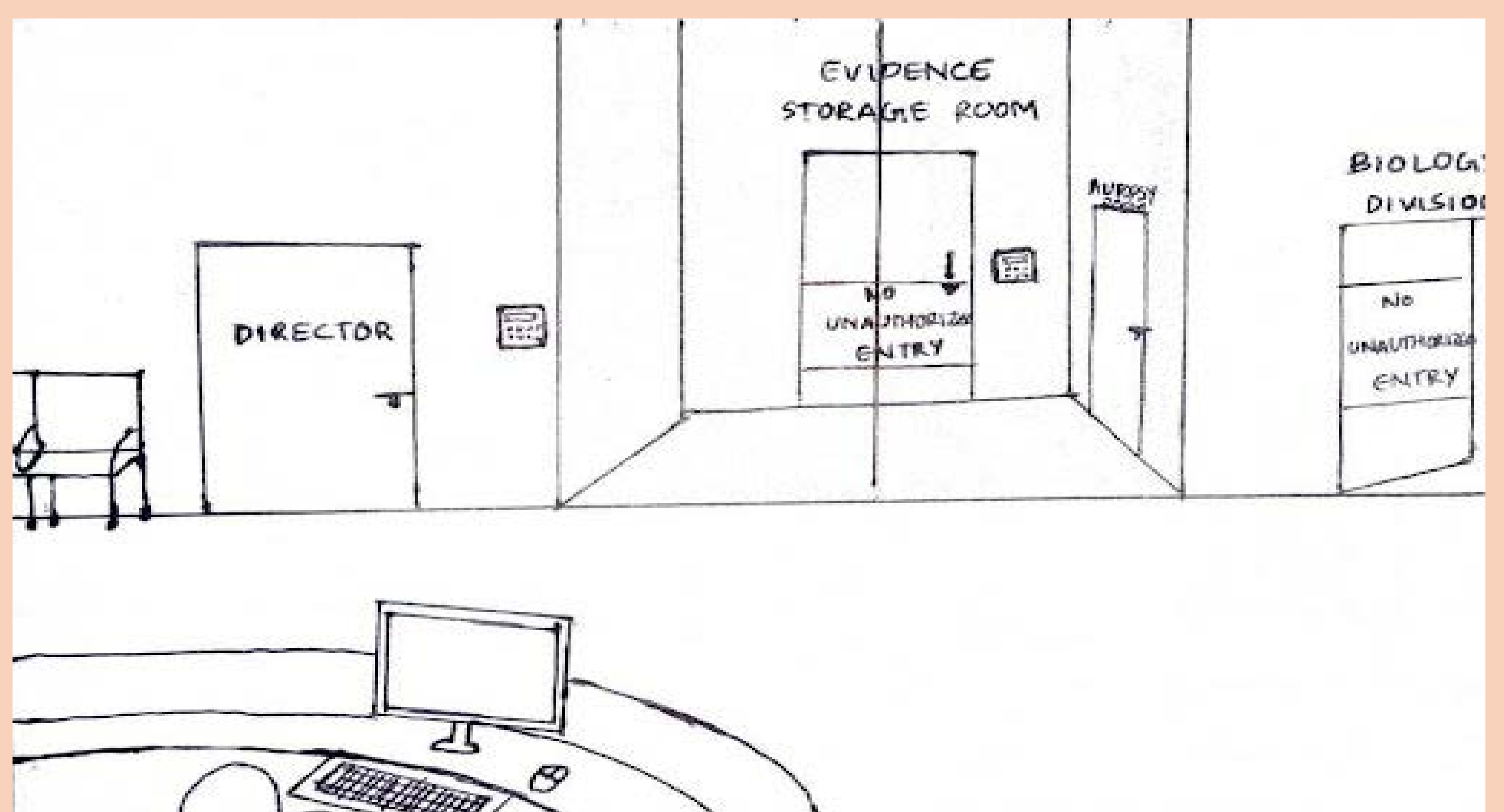
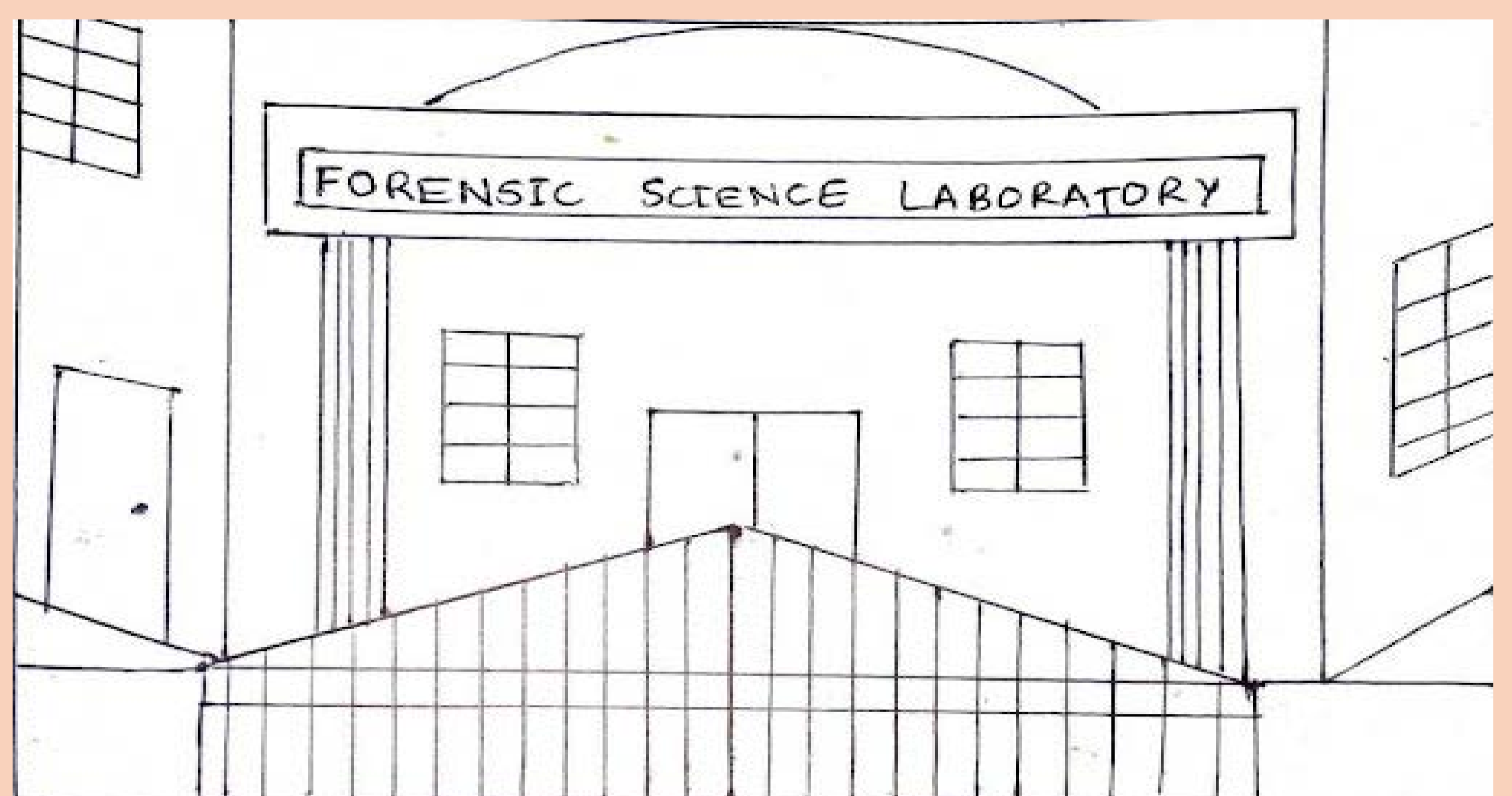



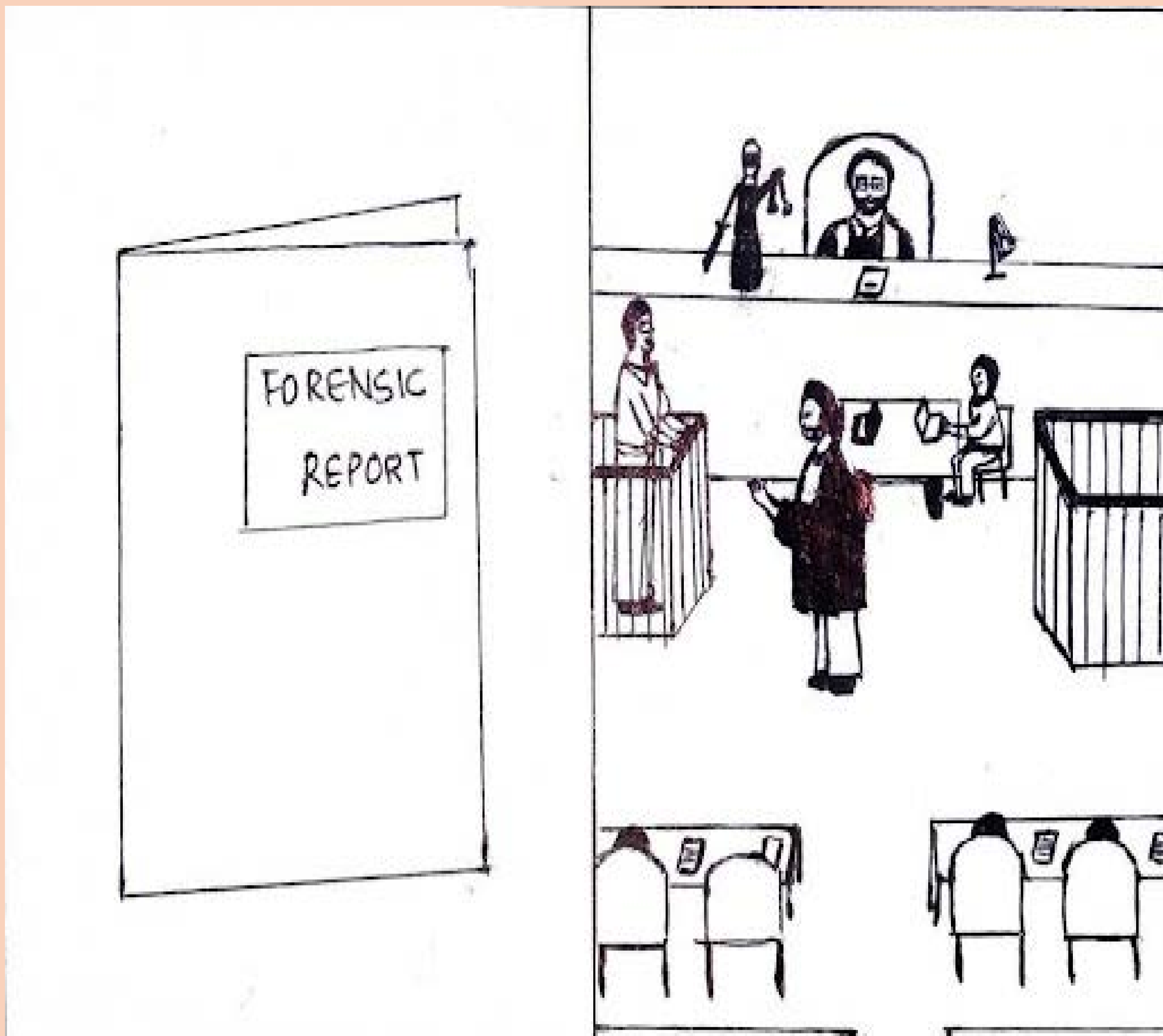

After receiving the report it is submitted to the court. The forensic scientist may be called upon to give expert testimony in court. Based on the investigation conducted the culprit may be identified from the suspects and the judge may give sentences based on the seriousness of the crime and serve justice to the victim and their family.

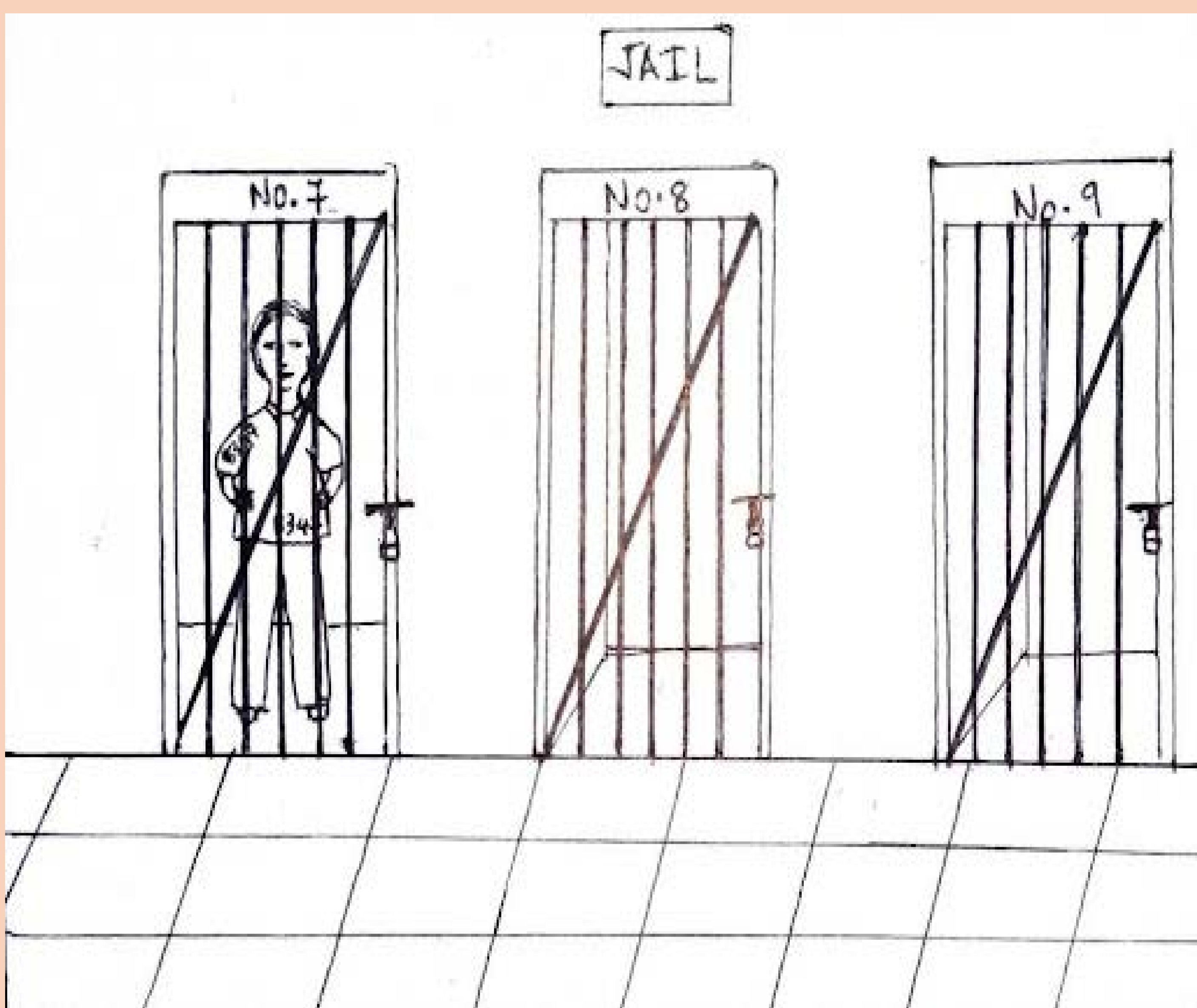

For every case, proper handling of the crime scene, determination and observation skills of the investigator and personal inferences are necessary to solve it. Remember, "Every contact leaves a trace"  
-Sir Edmund Locard